

Mechmaster's **DALEK STORM**

optimised for 3D printing by
John McAssey

Free model for non-commercial use

All parts should be prepared and test fitted before glueing in place.

You may wish to paint the parts before assembly.

Small parts should be kept away from young children.

1 Eyestalk assembly

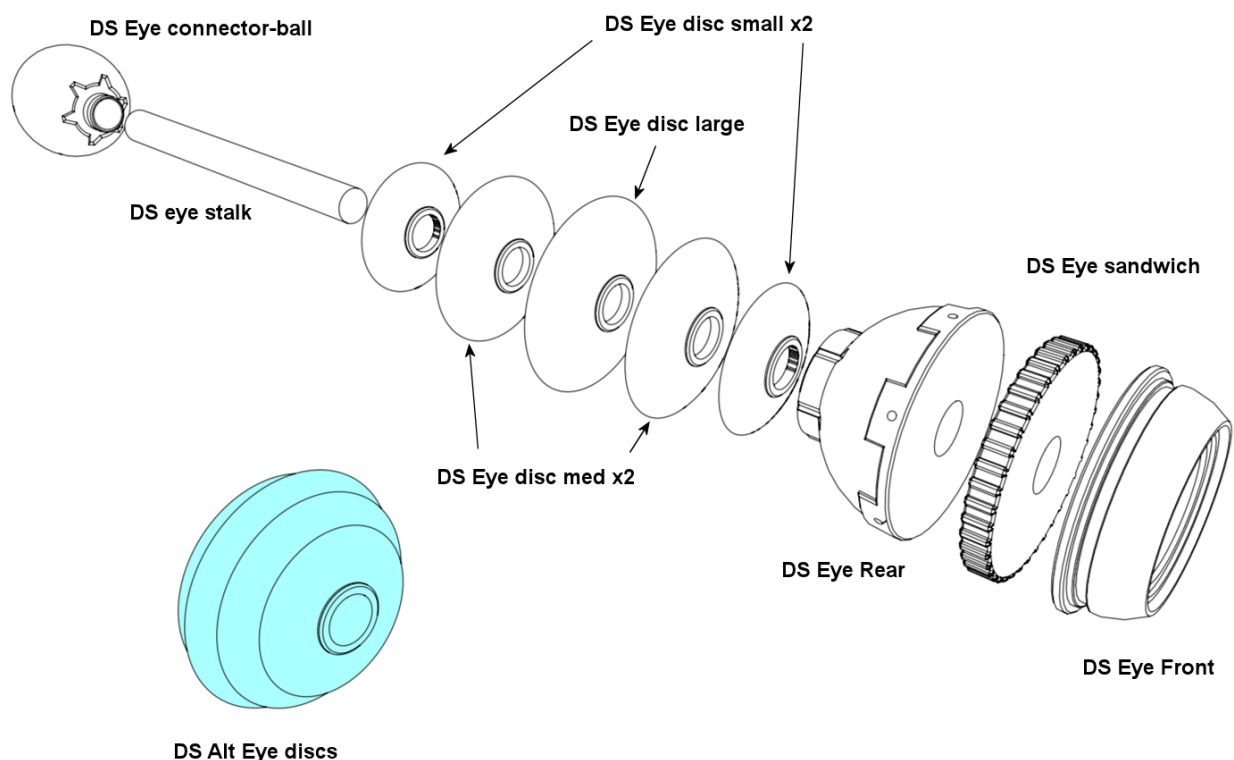

Insert *DS Eye stalk* into *DS Eye connector-ball* and thread the eye discs onto the stalk. Thread *DS Eye Rear* and *DS Eye Sandwich* onto the stalk and cap off with *DS Eye Front*. If you are unable to print the individual eye discs due to scale or printer limitations use the part *DS Alt Eye discs* instead. You may wish to replace the part *DS Eye stalk* with a suitable length of metal or plastic rod.

2 Dome assembly

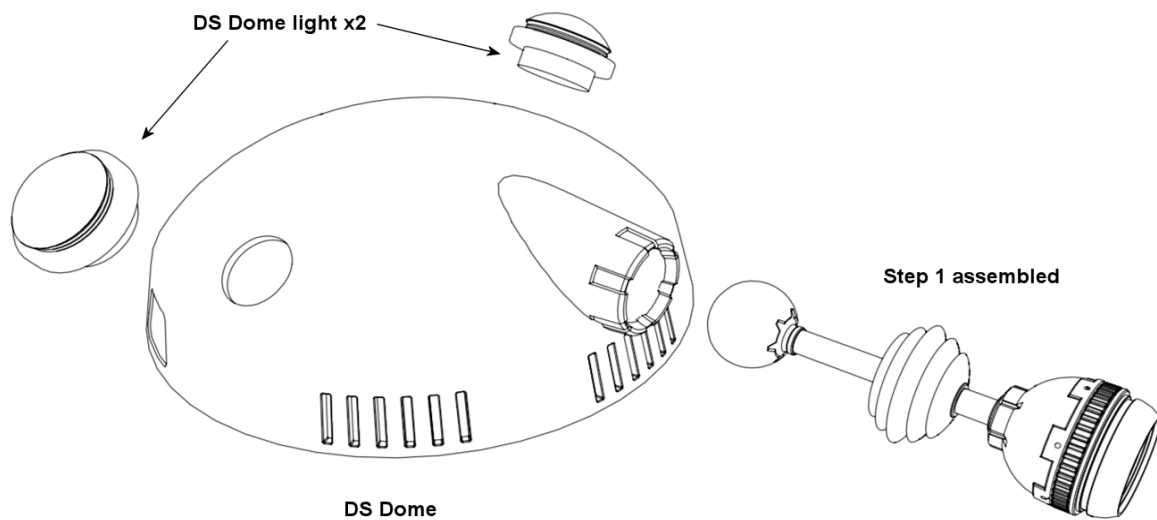

Insert the assembled eyestalk into the socket on the front of the *DS Dome* part and fit the lights into their sockets.

3 Neck assembly

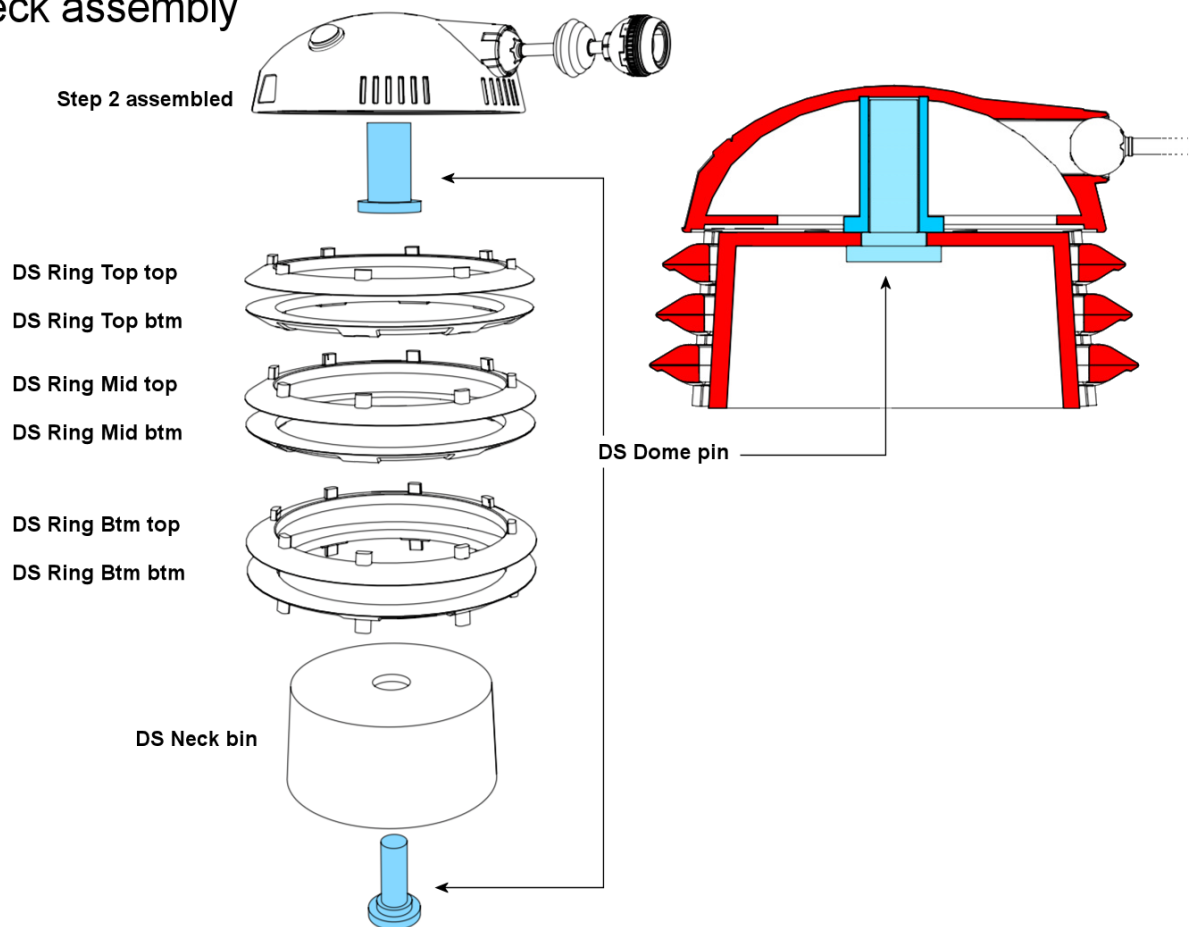

Glue the two halves of each neck ring together. Assemble the neck rings by fitting

the neck stanchions into the sockets in the bottom of the ring above and slide the neck rings over the neck bin. Push the inner part of the *DS Dome pin* through the hole in the top of the neck bin from below and press the outer sleeve of the *DS Dome pin* over the protruding part of the inner pin. Do not glue the *DS Dome pin* to the neck bin if you want the head dome to rotate freely. Glue the top of the *DS Dome pin* into the recess inside the assembled head dome.

4 Shoulder assembly

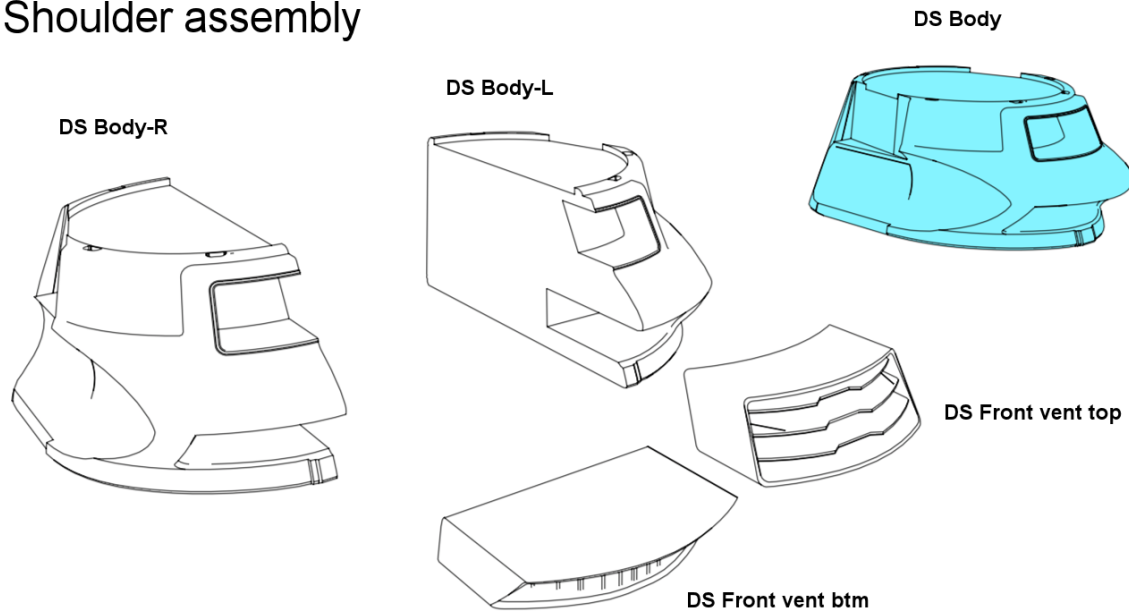

The shoulder section can be printed as a single piece using part *DS Body*, or in two halves using the parts *DS Body-L* and *DS Body-R*, choose the option which works best for your printer. Insert the front vents into the appropriate sockets.

5 Gun hub assembly **x2**

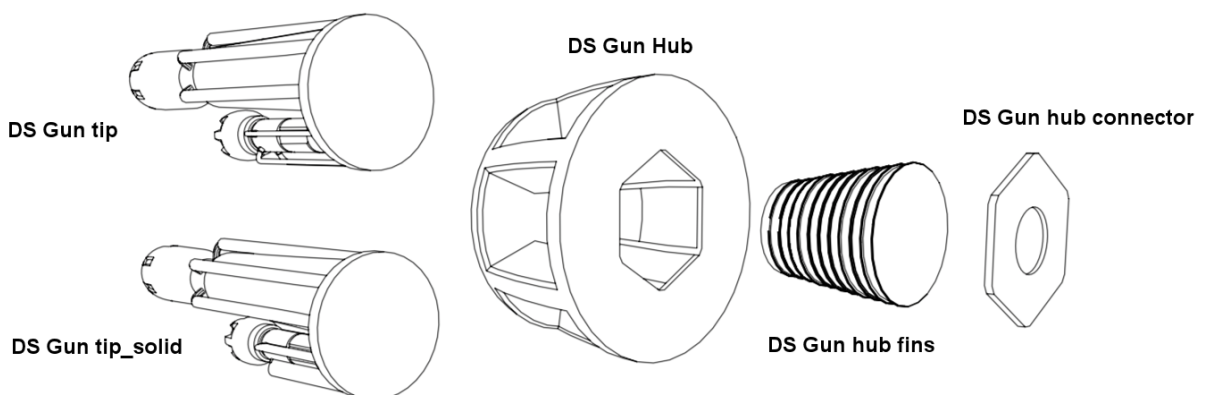

Insert the part *DS Gun hub fins* into *DS Gun hub* and glue *DS Gun hub connector* into the opening, ensuring that the part fits flush with the rear of the gun hub and that the recessed connection point is on the outside. Glue the part *DS Gun tip* to

the front of the gun hub. Some printers may not be capable of printing the fine wires on the guns, you could fabricate your own wires from fine brass rod (available from hobby stores) or print the part *DS Gun tip_solid* instead, this part has solid, in-filled wires which should print on most printers. Build **two** gun hubs.

6 Main gun assembly

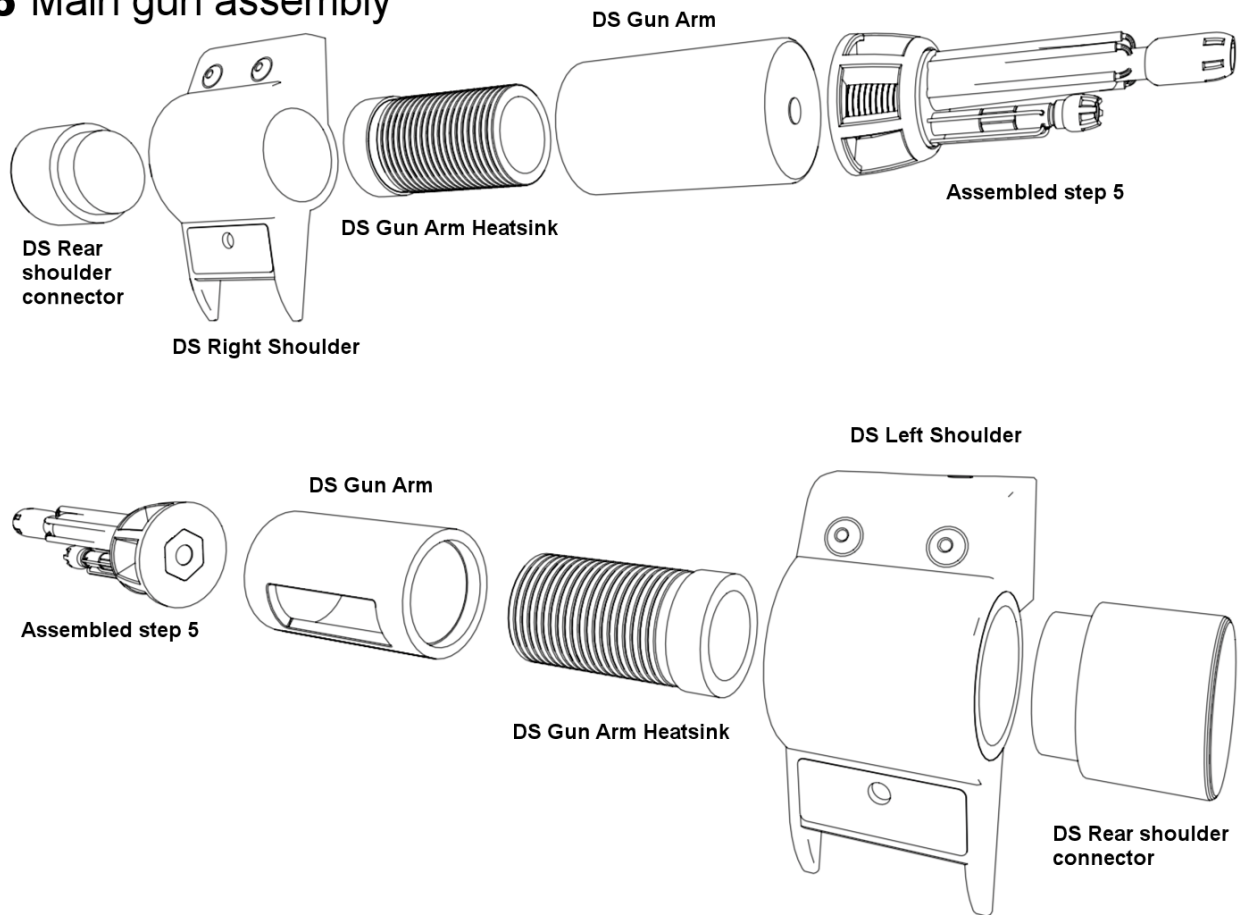

Insert the part *DS Gun Arm Heatsink* fully into the sleeve of *DS Gun Arm* and attach an assembled gun hub (Step 5) to the front of the sleeve. Create one of these assemblies for each side with the cut out in the arm sleeve in the lower, outside quadrant and attach one to the front of each shoulder section. Attach *DS Rear shoulder connector* to the rear of each shoulder section. Be careful to get these parts the right way round, the shoulder sections are wider at the rear.

Assembled shoulder unit (Left side)

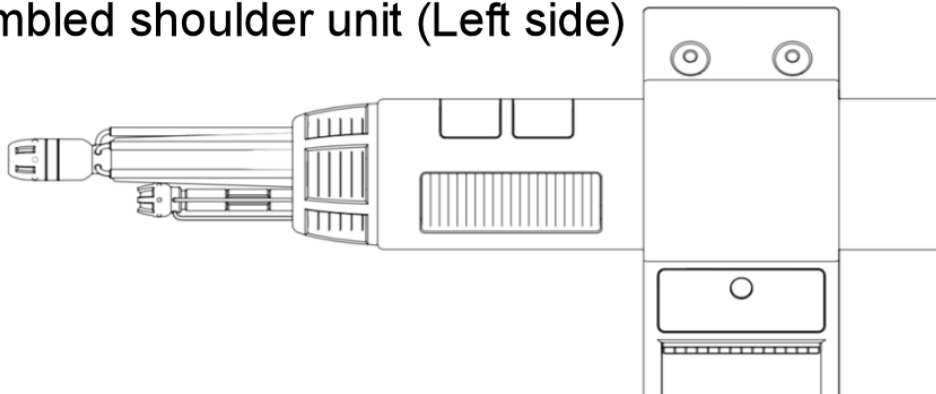

7 Upper body assembly

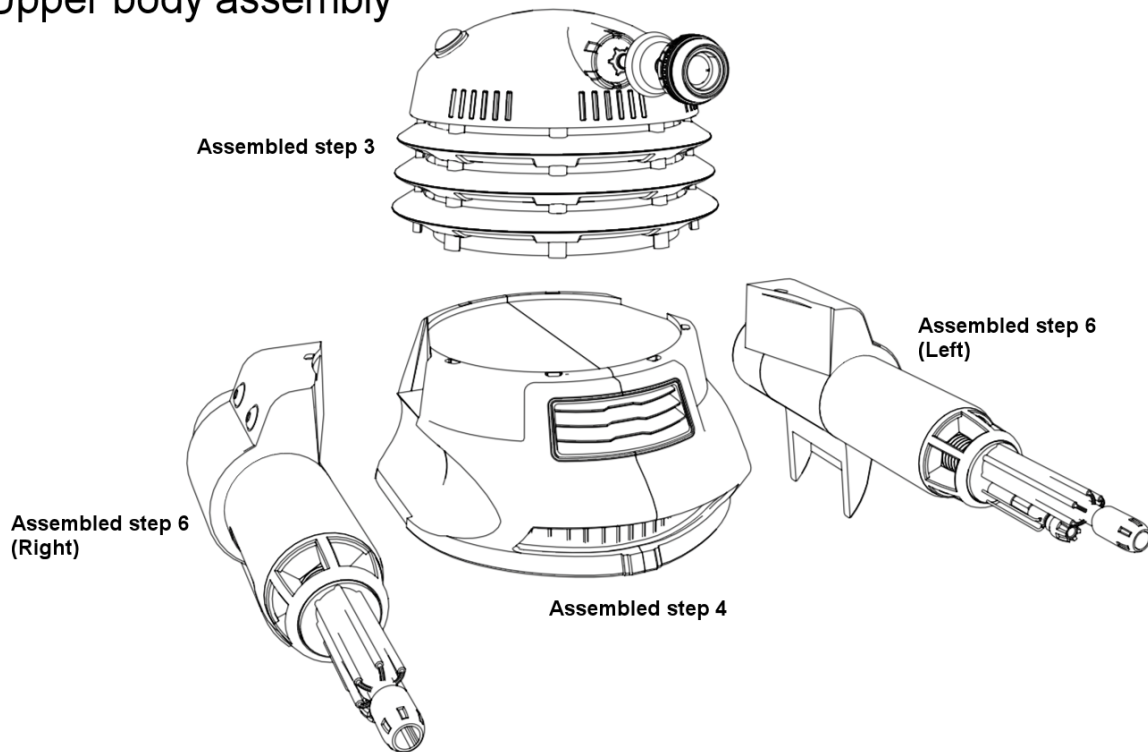

Attach the left and right cannon assemblies to the body and then attach the head and neck assembly, fitting the ends of the stanchions on the lower neck ring into the sockets on top of the body to ensure correct alignment.

8 Power pack assembly

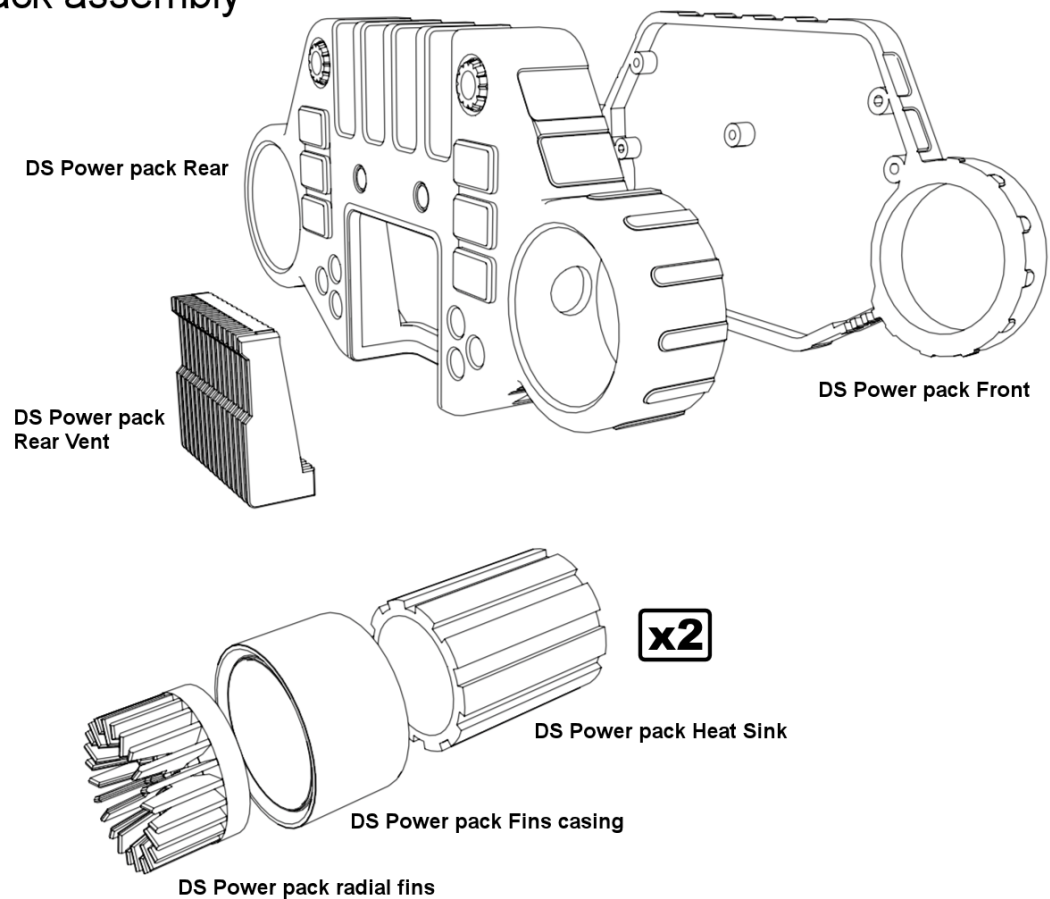

Glue the front and rear of the power pack together and glue the rear vent into place. Insert the *DS Power pack radial fins* part into the *DS Power pack Fins casing* and attach it to the rear of the *DS Power pack Heat Sink*. Make **two** of these assemblies.

9 Power pack attachment

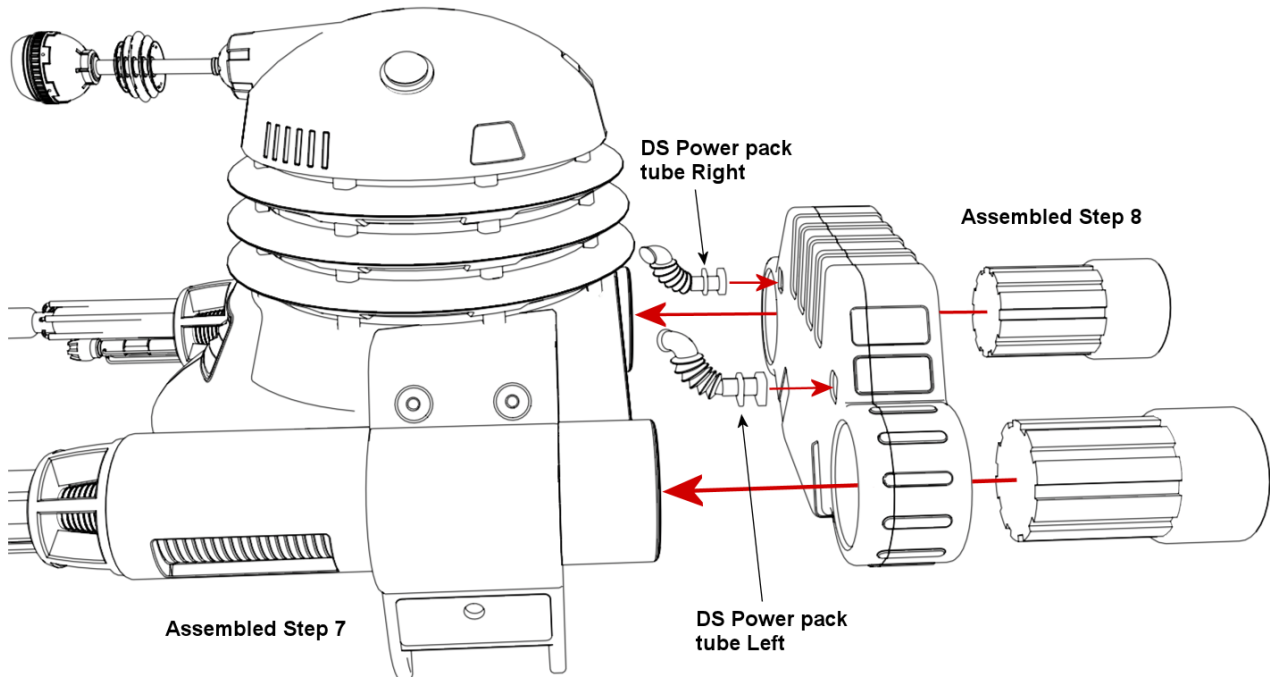

Attach *DS Power pack tube Left* and *DS Power pack tube Right* to the power pack. Feed the power pack heat sinks through the rings on the power pack and glue to the back of the rear shoulder connectors. Slide the power pack along the heat sinks until the front ends of the power pack tubes are in contact with the body.

10 Shoulder panel attachment

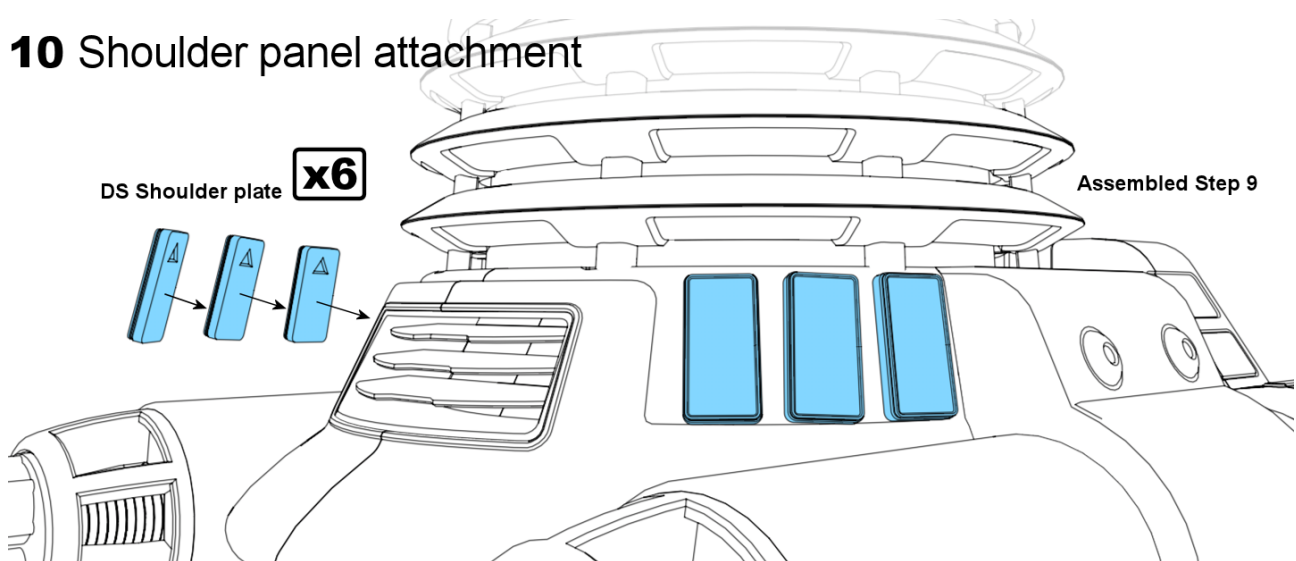

Attach three shoulder plates to the front of each side of the shoulders. The plates are slightly tapered, the arrow on the back of the plate indicates the top.

11 Lower body assembly

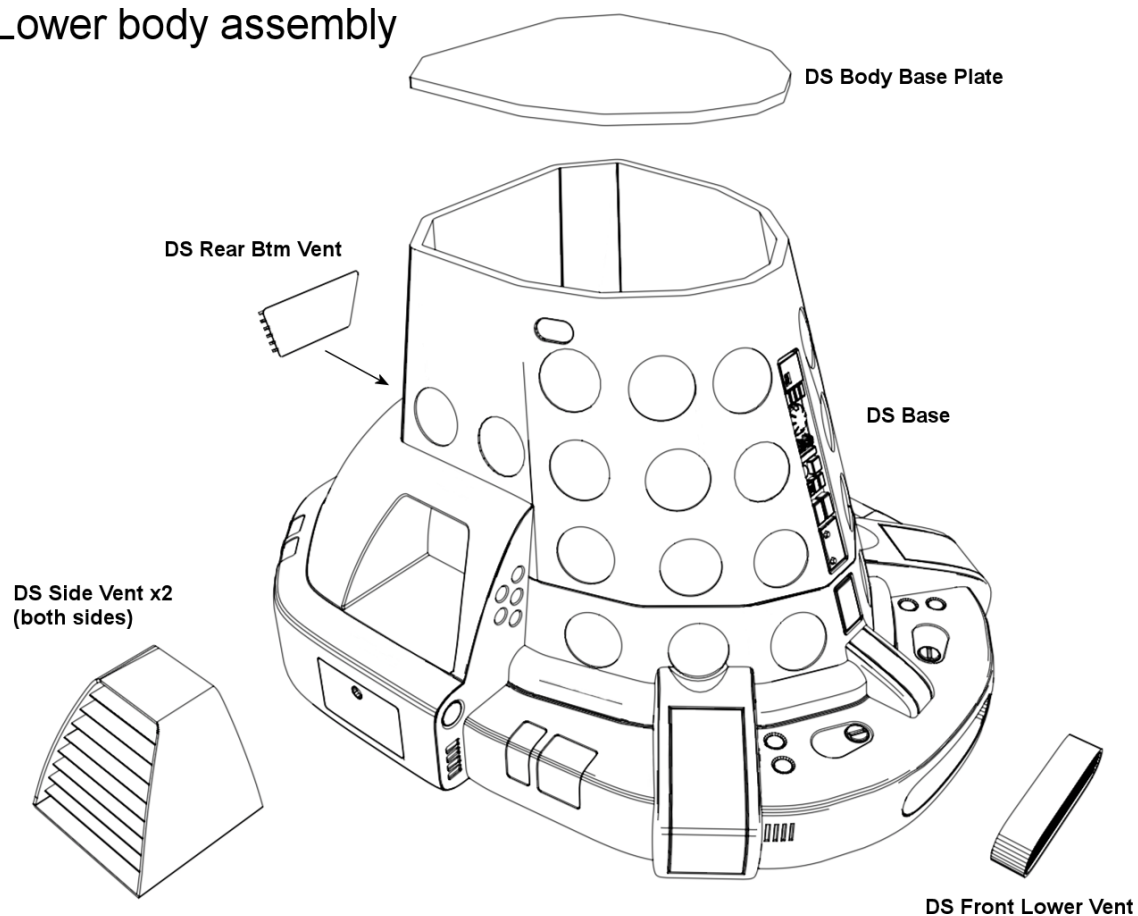

Glue the part *DS Body Base Plate* into the top of the skirt section and glue the vent pieces into the appropriate apertures around the base.

12 Final assembly

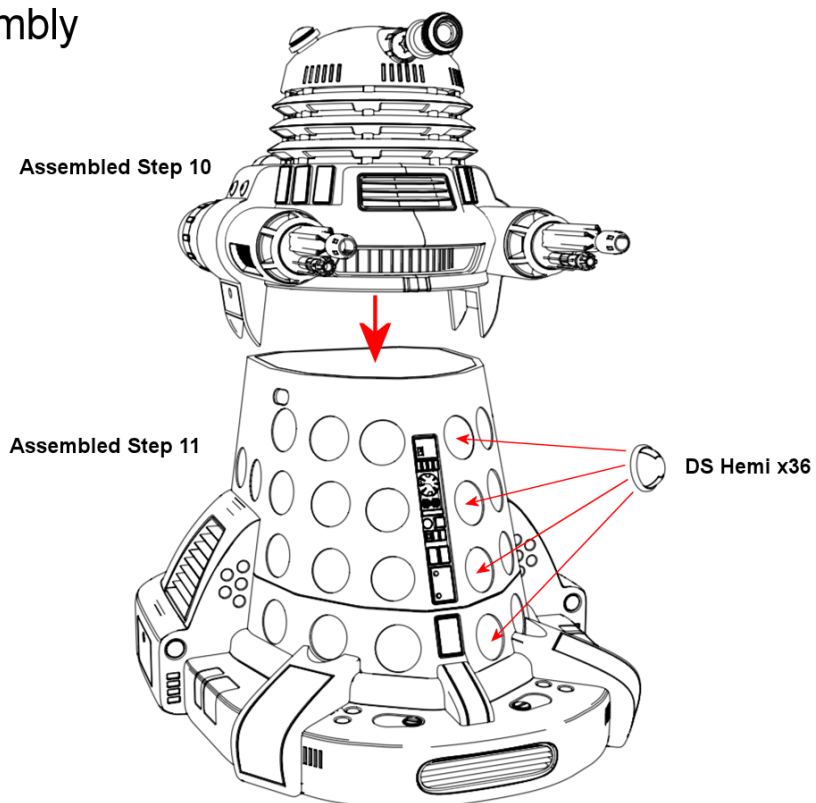

Attach the upper body to the lower body and fit 36 hemispheres into the sockets in the skirt section.



Mechmaster Dalek Storm assembly manual version 1.0

© Copyright Chris Smith, John McAssey 2022

email – mechmaster@cg-lair.co.uk